

## Projects

These intricate leaves can be used with the gift wrap on pages 32–33 and the ribbon on pages 40–41 to form part of a gift wrap set. Used on their own they'll be a lovely addition to any thoughtful gift.

**Tool kit**

- Bone folder
- Metal safeguard ruler
- Self-healing cutting mat
- Craft knife and blades
- Craft screw punch

**Materials**

- Heavy-weight cardstock in three colors
- Printer paper (optional)
- Sticky tape (optional)
- Double-sided tape
- Twine or ribbon

**Choosing materials**

The layers of this delicate gift tag need to be made on heavy-weight cardstock so that the tag keeps its shape and structure—about 110 lb cover (270 gsm). Heavy-weight cardstock is more difficult to cut through so it is not a good idea to cut the templates out from the back of the book as that will add another thick layer to cut through. It is better to use printer paper or, better yet, transfer the template directly onto your cardstock.



Template is on page 97

1 Turn to template 6 on page 97. Use one of the methods on page 16 to transfer the three parts of the template to your chosen cardstock. Alternatively, photocopy the template or access using the QR code and print onto regular printer paper, and tape to the cardstock. Whichever method you use, position the templates right of center on the cardstock and use a different color for each template.

2 Using a bone folder and metal ruler, fold the cardstock so that the center of the leaf aligns with the folded edge.

3 Using a craft knife on a cutting mat, start by carefully cutting out all of the internal shapes on the medium-sized leaf. To prevent the paper from shifting as you work, tape the two layers together at the open edge using double-sided tape. The tape will be cut off with the rest of the excess cardstock, so you'll be able to unfold the papercut later. Start by cutting the shapes nearest to the folded edge and then move outward.

4 Once all of the internal shapes have been cut, cut around the outline of the leaf and then unfold. Use a 2-mm punch to create a small hole at the center-bottom of the leaf shape.

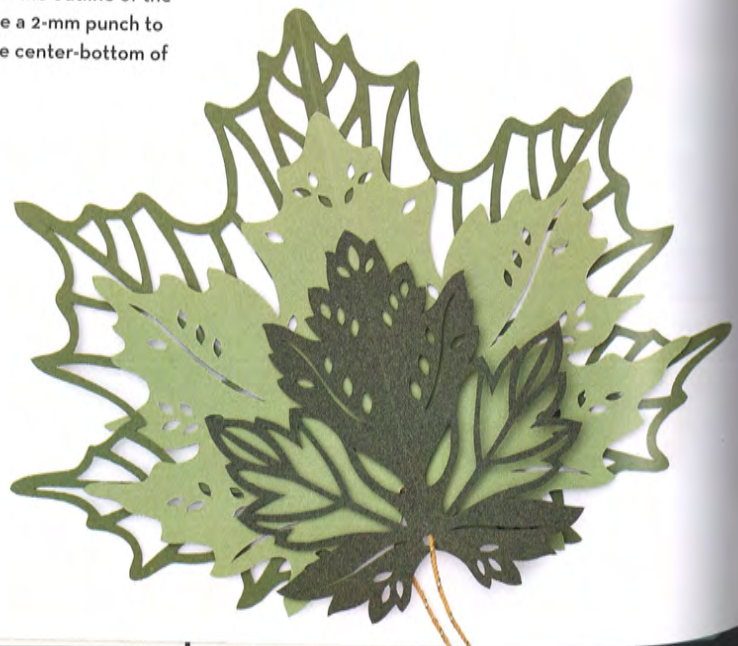
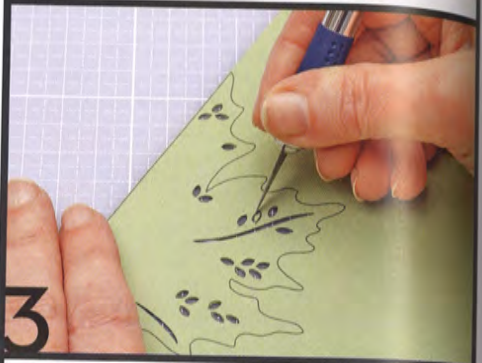



5



6

5 Repeat Steps 3-4 with the other two leaves.

6 Layer your leaf shapes with the largest at the back and the smallest at the front. Align the holes you've made at the bottom of each leaf. Cut a length of twine or ribbon and thread it through the three holes to join the three leaves, and knot to secure.



I bet you never thought you could create your own papercut gift wrap—but you can! This is guaranteed to wow your friends and it's fairly simple to create. You could even team it with the gift tag on pages 26–27 and the ribbon on pages 40–41 for an impressive set.

#### Tool kit

- Bone folder
- Metal safeguard ruler
- Pencil
- Self-healing cutting mat
- Craft knife and blades

#### Materials

- Printer paper
- Two sheets of wrapping paper in contrasting colors
- Carbon paper
- Sticky tape

#### Choosing materials

You'll be cutting through eight layers of paper at a time so a nice, thin wrapping paper of about 20 lb bond (75 gsm) would be ideal. The thinner the paper, the easier it will be to cut. Think about the color of the papers you choose, as one will show through the other. Go for a bold contrast or stick to more similar colors for a subtle design.



Template is on page 95

**1** Cut out template 5 on page 95. To use the template more than once, print or copy the template using one of the methods on page 16. You will be transferring the design onto your chosen paper.

**2** Take the wrapping paper that will feature the papercut design and fold it in half lengthwise three times. If the wrapping paper is colored on only one side, make sure that you fold it with the colored side inside. The sheets of wrapping paper used in this example are 18 x 25½ inches (45 x 65 cm) in size.

**3** You will be cutting through multiple layers here, and adding another layer in the form of a template (even just printer paper) will make cutting more difficult, so it's best to transfer the template directly to the paper. Tape the folded wrapping paper to the cutting mat so the layers don't shift, and place a piece of carbon paper on top. Align the template on top of the carbon paper and tape this firmly onto the mat so it doesn't move.

**4** Carefully trace over the template with a pencil. This will transfer the design onto the top layer of wrapping paper. Remove the tape and discard the template and carbon paper.

**5** Using a craft knife on a cutting mat, cut the leaves one by one. If you're left-handed, cut from right to left. If you're right-handed, cut from left to right. This will stop your hand from dragging and ripping the thin wrapping paper.

**6** Unfold the wrapping paper to reveal your design. Layer the papercut wrapping paper over a plain wrapping paper in a contrasting color to make your gift wrapping really interesting.





This project is a lovely way to add a personal touch to a beautifully wrapped gift. It's wonderful on its own, or you could combine it with the gift tag on pages 26–27 and the gift wrap on pages 32–33 for a complete set.

#### Tool kit

- Bone folder
- Metal safeguard ruler
- Pencil
- Self-healing cutting mat
- Craft knife and blades

#### Materials

- Printer paper
- Paper
- Carbon paper
- Sticky tape

#### Choosing materials

You want to be able to wrap your papercut ribbon easily around a gift, just as you would a fabric ribbon, so you don't want to use thick cardstock here. I would recommend 28 lb bond (105 gsm) paper instead. You may also be cutting through multiple layers, so a thinner paper will make your life easier.



Template is on page 97

1 Turn to template 7 on page 97. You may need to resize this template to suit your specific needs. For example, if you need an 18-inch (45-cm) length of ribbon, resize the template to 6 inches (15 cm) long. Use the QR code to access the templates on your computer, resize the template to the desired size, and print onto printer paper. Alternatively, you can resize the templates using a photocopier.

2 Take your chosen paper and, using a bone folder and metal ruler, accordion fold the paper (see page 13) to fit your template. In this example, my template is 6 inches (15 cm) long, so I will accordion fold my 18-inch (45-cm) strip of paper every 6 inches (15 cm). Remember that the more layers of paper you have, the harder it will be to cut through.

3 You will be cutting through multiple layers here, and adding another layer in the form of a template (even just printer paper) will make cutting more difficult, so it's best to transfer the template directly to the paper with carbon paper. Tape the accordion-folded paper to the cutting mat so the layers don't shift and place a piece of carbon paper on top. Align the template on top of the carbon paper and tape this firmly onto the mat so it doesn't move.

4 Carefully trace over the template with a pencil. This will transfer the design onto the top layer of your folded paper. Remove the tape and discard the template and carbon paper.

5 Using a craft knife and metal ruler on a cutting mat, begin by cutting all of the small shapes—the lines and the leaves—in the center of the design.

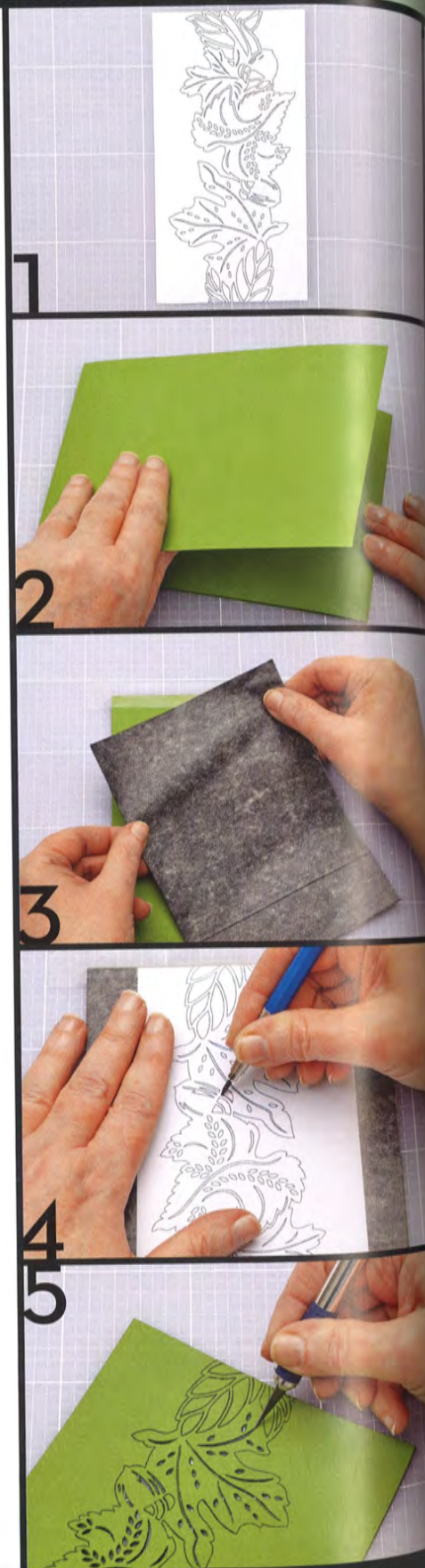



6 Cut the details on the acorns and the larger leaves toward the ends of the template. Take particular care here—be careful not to cut through the connecting paper in the folds.



7 Now focus on cutting the outline of the template.



8 Unfold the papercut ribbon. Carefully wrap it around your gift, making sure to put the side you drew on face down in case of any remaining pencil marks. Add more sections as needed and tape together in place for instant gift impact.





TEMPLATE 5  
Leafy Gift Wrap, pages 32-33



TEMPLATE 6  
Leafy Gift Tag,  
pages 26-27

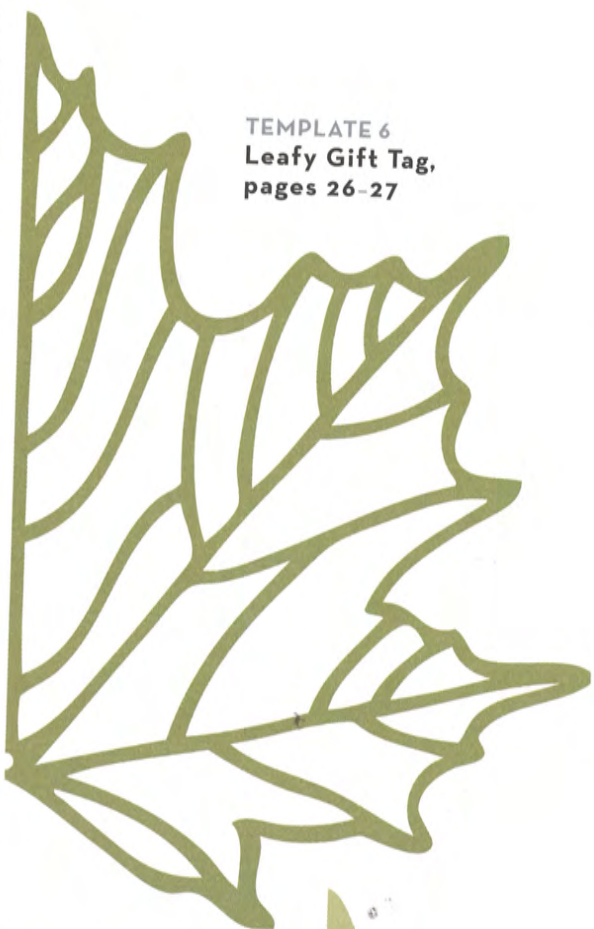

TEMPLATE 7  
Leafy Ribbon,  
pages 40-41





SUPER-SYMMETRICAL PAPER-CUT PATTERNS FOR ARTWORK,  
KEEPSAKES, GREETING CARDS, AND MORE

# FOLD IT



INCLUDES 48 TEMPLATES TO CUT OR TRACE

NAOMI SHIEK